

Series 2800

V2 834PL2

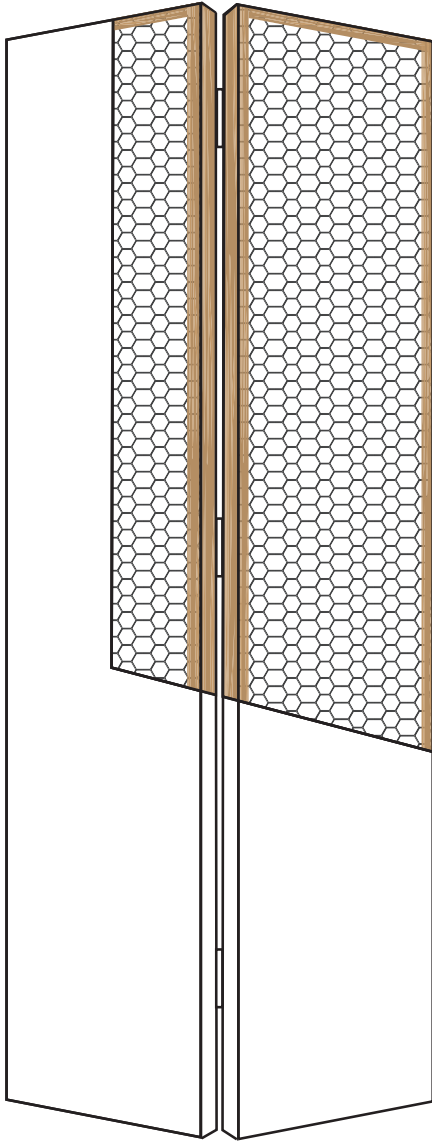

SPECIFICATIONS DESCRIPTION

| | |
|-----------------|--|
| Rails | 1 1/4 (32 mm) low-density wood |
| Stiles | 1 1/4 (32 mm) low-density wood |
| Core | Hollow with honeycomb, 1 (25 mm) cells, 11 PSI |
| Face | 4 mm HDF (850 kg/cbm) as selected |
| Glue | type II, water-resistant, ASTM E2074 standard formaldehyde free |
| Hinge | Heavy-duty installed |
| Warranty | 1 year against warping |

*Dimensions are nominal before trimming

Designer series (HDF premium)

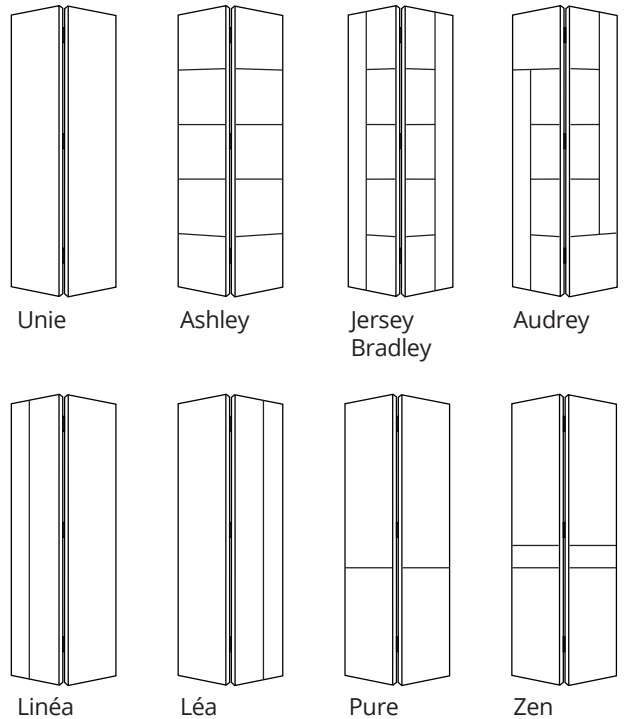

Intertek

All doors manufactured by ID Doors comply with the standards of the Canadian Standards Association. CAN/CSA-0132.2.0.90.