

Series 3800

V3 838PL2

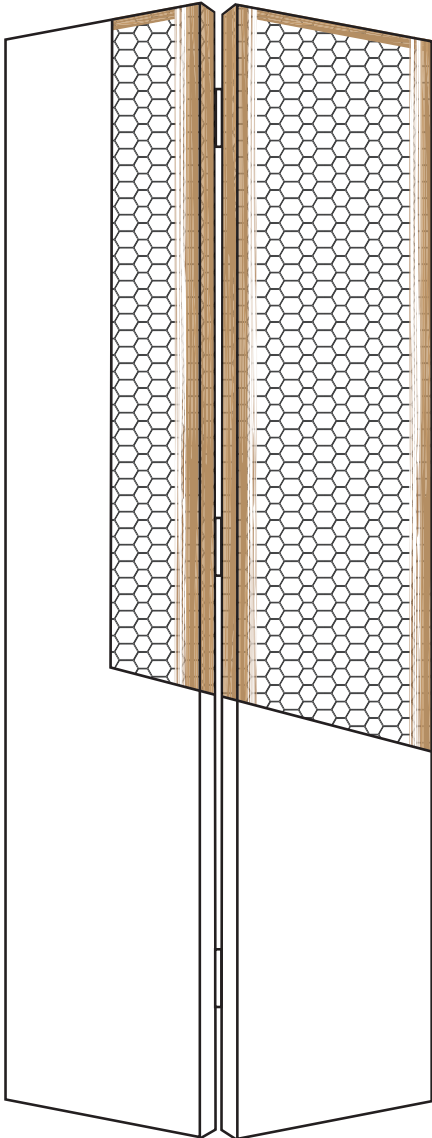

SPECIFICATIONS DESCRIPTION

<b>Rails</b>	1 1/8 (29 mm) low-density wood
<b>Stiles</b>	2 7/8 (73 mm) LSL type including 0,390 (10 mm) wood, preferably matching veneer
<b>Core</b>	Hollow with honeycomb, 1 (25 mm) cells, 11 PSI
<b>Face</b>	4 mm HDF (850 kg/cbm) as selected
<b>Glue</b>	type II, water-resistant, ASTM E2074 standard formaldehyde free
<b>Hinge</b>	<b>Heavy-duty</b> installed
<b>Warranty</b>	3 years against warping

\*Dimensions are nominal before trimming

Designer series (HDF premium)

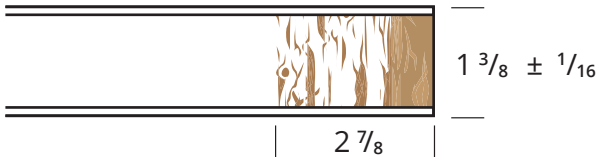
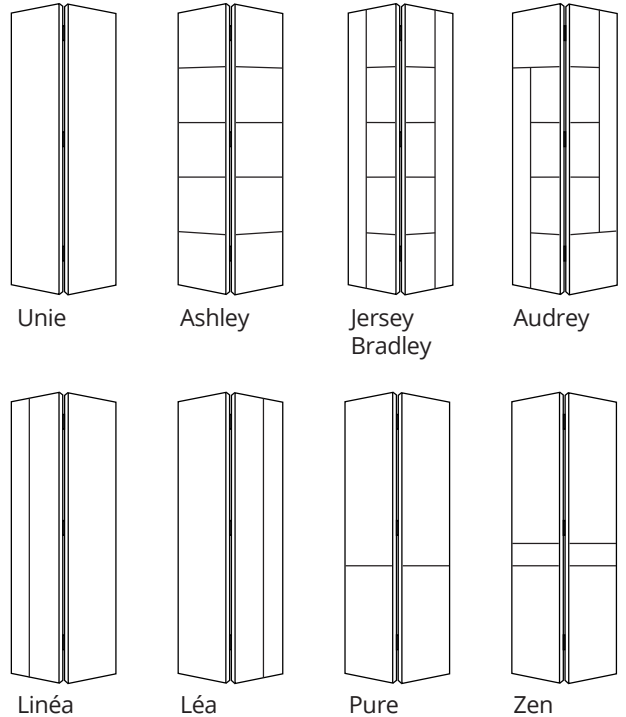

Intertek

All doors manufactured by ID Doors comply with the standards of the Canadian Standards Association. CAN/CSA-0132.2.0.90.